

**E-LBWW SERIES  
T5 LOW BAY WIDE WRAP LUMINAIRE**



<p><b>Housing:</b> 22GA steel.  <b>Finish:</b> Baked white enamel, galvanized or post powdercoat steel.  <b>Construction:</b> CNC formed and mechanically joined.  <b>Options:</b> 11GA wireguard, prismatic or clear lens.</p>			<p><b>Mounting:</b> Suspended or surface mounted.  <b>Distribution:</b> Medium to wide. Replacement for HID low bay.  <b>Electrical:</b> Electronic Standard or High output options; Program Start Ballast is factory standard; &lt;10% THD; Inherent thermal protection; Dimming &amp; Emergency available.  <b>Labels:</b> UL/CUL listed. Damp Location.</p>		
SPEC.	NOM.	DESCRIPTION	SPEC.	NOM.	DESCRIPTION
Finish	P	Powdercoat <b>gloss white</b>	Lens	---	Open - no designation needed A12 prismatic acrylic .110" thick
	G	Galvanized		PR	
	W	Baked white enamel			
Dimension	14	Nominal 8" wide x 48" long	Voltage	U	Universal volt 120-277 (factory standard) 347-480 volt 1 120 volt (specify with LED or dimming) 2 277 volt (specify with LED or dimming) 3 347 volt (specify with LED or dimming) 4 480 volt (specify with LED or dimming) 1B Emergency Battery Back-up 120v 2B Emergency Battery Back-up 277v (T5 std = 500 lumens or T5HO = 825 lumens)
				H	
1					
2					
3					
4					
1B					
2B					
Lamping	4	<p><b>T5 = 54W or 28W per lamp</b>  <b>Lamps are not included unless otherwise noted</b>            (4) lamps in cross section            LED – contact factory &amp; specify voltage</p>	Reflector	E	Enhanced Aluminum 95% reflective White Aluminum 90%+ reflective
				L	
Ballast	S5	<p><b>T5</b>            Standard Electronic T5 28W            High Output Electronic T5 54W            Dimming Standard Electronic T5 28W – specify type &amp; voltage            Dimming High Output Electronic T5 54W – specify type &amp; voltage</p>	Mounting	---	Surface Mounted (standard) - no designation needed Chain Suspended (by others) - no designation needed 2.5" Single Point Box (stem mount) 8ft Powercord, black 18/3 wire Y-fit Grippler® Toggle 6" Y x 8' long Shows as separate line item on order: part# H-Y6"HNGR-10'
	H5				
	DS				
	DH				
	LED				
LDD	LED	LED Transformer – contact factory LED Dimming Transformer – contact factory	Options	O	360° degree occupancy sensor Aisle occupancy sensor Relay Multi-circuit wiring
				A	
				R	
				M	

**ORDERING NOMENCLATURE GUIDE**

**Standard Fixture: E-LBWW144H5UE**  
 Catalog # for a LBW Type Fixture – Baked White Enamel - Nominal 1 ft x 4 ft Long - 4 Lamps in cross section - High Output T5 Electronic Ballast - Open/No Lens - Universal Voltage - Enhanced Reflector - Standard Surface Mount - No Options.

8E Product	Series	Finish	Dimension	Lamping	Ballast	Lens	Voltage	Reflector	Mounting	Options
<b>E -</b>	<b>LBW</b>									

**E-LBWW SERIES  
 T5 LOW BAY WIDE WRAP LUMINAIRE**

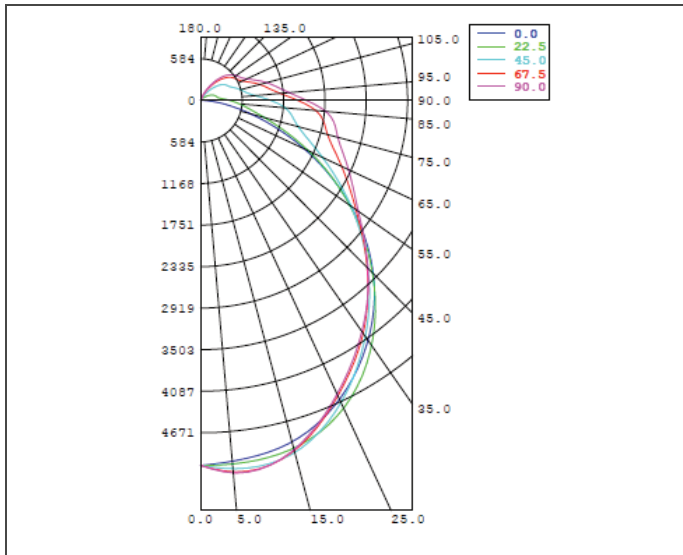
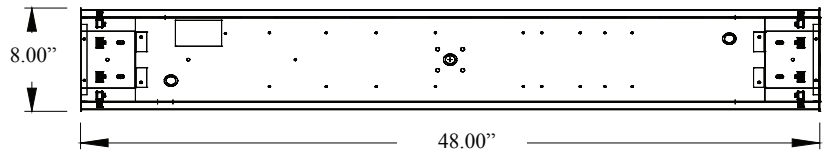
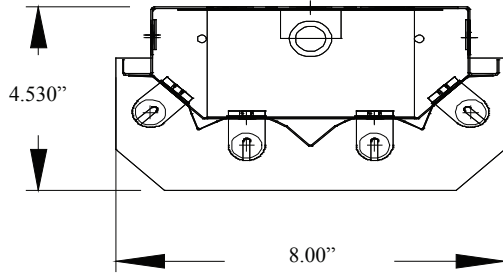

**PRODUCT NUMBER** = E-LBWW144H5UE  
**FIXTURE EFFICIENCY** = 92.9%  
**S.M.H.** = 1.28  
**WATTAGE** = 234W (BASED ON 277V)  
 RCR TABLE AVAILABLE  
 IES PHOTOMETRIC FILE AVAILABLE

**SPECIFICATION CHARACTERISTICS**

- **Medium to Wide Distribution Utilizing Energy Efficient Components Throughout**
- **Highly Efficient Luminaire – Over 92%**
- **Replaces 250 - 400 Watt HID Low Bay**
- **Instant On, Long Life, Lower Energy Consumption, No Color Shift**
- **T5 Application = 36,000 Hours (based on 12 hour starts)**
- **Uniform Illumination**
- **LED is Available – Contact Factory with Requirements**
- **Vented for Optimum Lamp Performance**
- **Quick-Wire Access Plate**
- **Dimming, Emergency, Occupancy Sensor or Light Level Sensor Options**
- **Multiple Mounting Options: Surface Mount, Chain or Gripple Ready, Single Point Mounting Box or Cord**
- **Multiple Finish Options: Gloss White Post Powdercoated, Galvanized or Baked White Enamel Steel**
- **Short Lead Times**