

**E-RW SERIES
T8 RADIAL LENS WIDE WRAP**



| <p>Housing: 22GA steel. Finish: Baked white enamel or post powdercoat steel. Construction: CNC formed and mechanically joined. Lens: Proprietary high-performance, radial, linear lens.</p> | | | <p>Mounting: Surface mounted. Distribution: Wide. Electrical: Electronic Low, Standard or High output options; Instant Start is factory standard; <10% THD; Inherent thermal protection; Dimming & Emergency available. Labels: UL/CUL listed. Damp Location.</p> | | |
|---|---|---|--|--|---|
| SPEC. | NOM. | DESCRIPTION | SPEC. | NOM. | DESCRIPTION |
| Finish | --- | Baked white enamel – no designation needed | Lens | RL | Radial linear acrylic |
| Dimension | 12 14 18 | Nominal 12" wide x 24" long Nominal 12" wide x 48" long Nominal 12" wide x 96" long | Voltage | U H 1 2 3 4 1B 2B | Universal volt 120-277 (factory standard) 347-480 volt 120 volt (specify with LED or dimming) 277 volt (specify with LED or dimming) 347 volt (specify with LED or dimming) 480 volt (specify with LED or dimming) Emergency Battery Back-up 120v Emergency Battery Back-up 277v (T8 = 500 lumens factory standard) |
| Lamping | 1 2 4 6 L | T8 = 32W, 17W per lamp Lamps are not included unless otherwise noted (1) lamp in cross section (2,4ft) (2) lamps in cross section (2,4ft); 1 in cross (8ft) (4) lamps - 2 in cross section (8ft only) (6) lamps - 3 in cross section (8ft only) LED – contact factory & specify voltage | Reflector | E W | Enhanced Aluminum 95% reflective White Aluminum 90%+ reflective |
| Ballast | S L H D P SP HP LED LDD | T8 Standard Electronic T8 Low Output Electronic T8 High Output Electronic T8 Electronic Dimming T8 – specify type & voltage Program Start Electronic T8 Standard Output/Program Start Combination T8 High Output/Program Start Combination T8 LED LED Transformer – contact factory LED Dimming Transformer – contact factory | Mounting | --- | Surface Mounted (standard) - no designation needed |
| | | | Options | P O M | Photocell Open 360° Occupancy Sensor Multi-circuit wiring |

ORDERING NOMENCLATURE GUIDE

Standard Fixture: E-RW142SRLUE
Catalog # for a RW Type Fixture – Baked White Enamel - Nominal 1ft x 4 ft Long - 2 Lamps in cross section - Standard T8 Electronic Ballast - Radial Lens - Universal Voltage - Enhanced Reflector - Standard Surface Mount - No Options.

| 8E Product | Series | Finish | Dimension | Lamping | Ballast | Lens | Voltage | Reflector | Mounting | Options |
|------------|-----------|--------|-----------|---------|---------|------|---------|-----------|----------|---------|
| E - | RW | | | | | | | | | |

**E-RW SERIES
T8 RADIAL LENS WIDE WRAP**

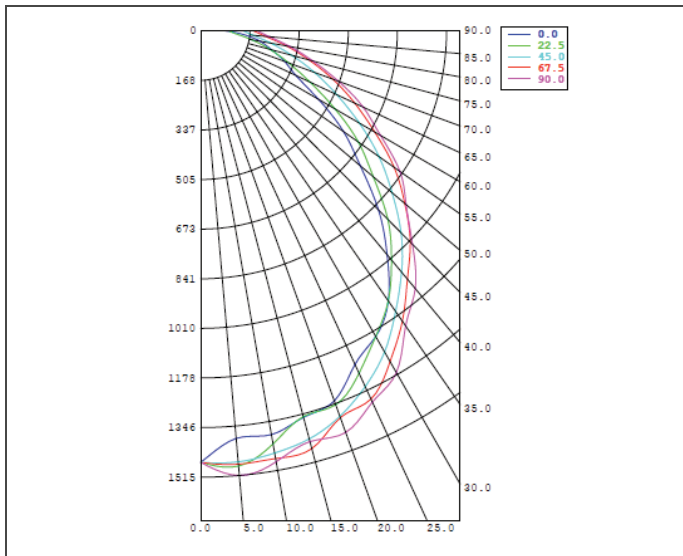
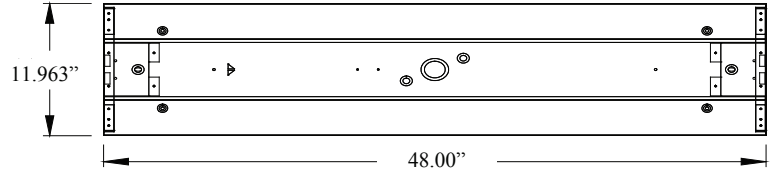
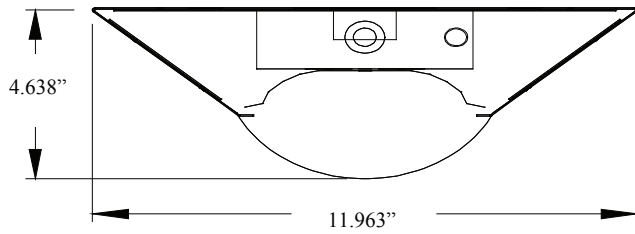

PRODUCT NUMBER = E-RW142SRLUE

FIXTURE EFFICIENCY = 71.7%

S.M.H. = 1.32

WATTAGE = 52W (BASED ON 277V)

RCR TABLE AVAILABLE

IES PHOTOMETRIC FILE AVAILABLE

SPECIFICATION CHARACTERISTICS

- **Wide Distribution Utilizing Energy Efficient Components Throughout**
- **Highly Efficient Luminaire – Over 71%**
- **Use to Cover Up Existing 12" Fixture Footprint**
- **Instant On, Long Life, Lower Energy Consumption, No Color Shift**
- **Uniform Illumination**
- **LED is Available – Contact Factory with Requirements**
- **Dimming, Emergency Options**
- **Photocell, Sensor Options**
- **Proprietary Radial Linear Acrylic Lens for Wide, Even Distribution**
- **Multiple Finish Options: Gloss White Post Powdercoat or Baked White Enamel Steel**
- **Short Lead Times**